



## Product Specification Sheet: M1000

### Product Description:

A modular, replaceable, sanitary, single-piece ablution (wuthu') fixture for Mosques and Islamic centres. Strong and durable gelcoat moulded, fibreglass construction with a 3-year warranty. Ergonomically designed, the M1000 is intended to reduce construction and design costs and time while facilitating proper water drainage and eliminating water pooling and stagnation.

### Product Features:

- Single piece, integrated seat and water drainage basin.
- Made of fibreglass reinforced sanitary gelcoat.
- Modular design for multiple unit installations.
- Side splash walls, textured foot surfaces.
- Foot rest for foot washing.
- Wide range of colours available.

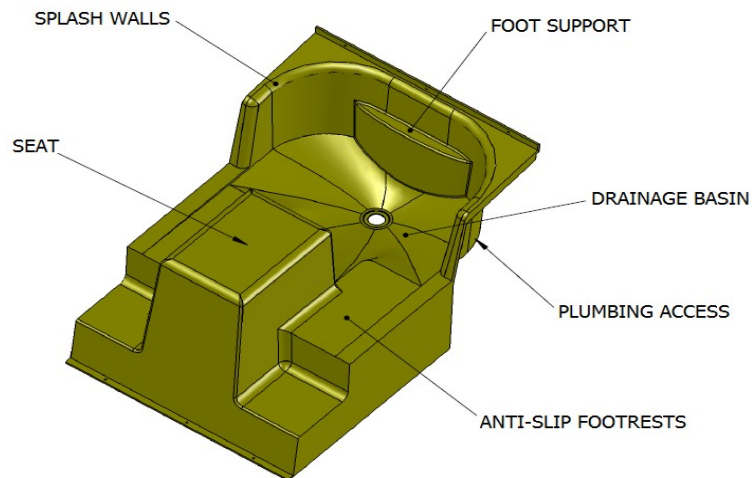

### Product Benefits:

- Ergonomic design and durable construction.
- Facilitates proper drainage with no accumulation of water.
- Sanitary, mold/mildew growth inhibitor.
- Quick installation with reduced design time.
- No additional framing construction required.
- Replaceable units, easily integrated into existing facilities.

### Technical Specifications:

**Height:** 24.5" (62.23 cm)

**Length:** 42.0" (106.68 cm)

**Width:** 30.0" (76.20 cm)

**Weight:** 55 lbs (25 kg)

**Wall Thickness:** 3/16" (5 mm)

**Capacity:** 600 lbs (272 kg)

**Certifications:** CSA (material only)

**Material:** Sanitary Gelcoat +  
Fibreglass Reinforcement

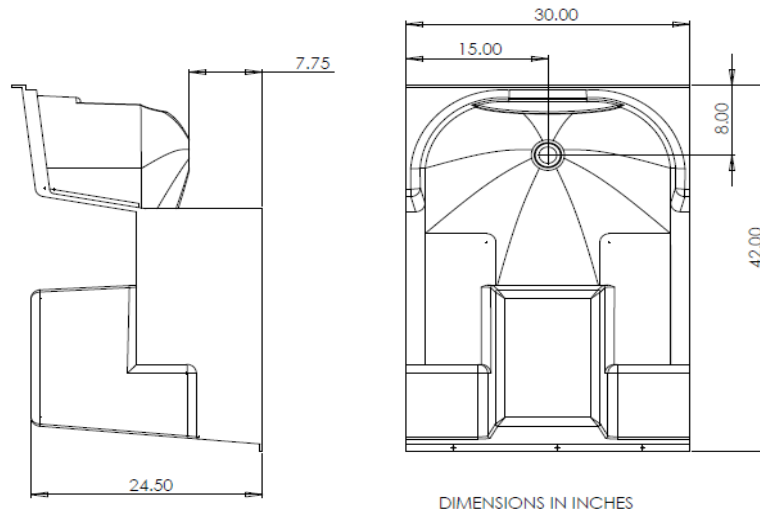

### Frequently Asked Questions:

Q: How many units can be installed together?

A: Up to 8 units can be installed together on a single plumbing line.

Q: Where are the units made and where do they ship from?

A: The units are made in Kitchener, Ontario and ship from there.

Q: What is the lead time?

A: The lead time is dependant on a number of factors but generally 1 week + 1.5 days per unit. Please contact us for an accurate lead time.

Q: Are there any dealers in the United States?

A: No, all orders to the United States are handled through our sales office in Canada.

Q: Are there any dealers in Europe or the Middle East?

A: Currently there is not but we are in talks with potential distribution partners in those markets.

Q: Can the units be replaced or moved easily?

A: Yes! The units are designed to be easily removed and reinstalled with little removal of tiling.

Q: What colours are available?

A: Colours can be selected online:

[http://www.sogel.ca/images/stories/pdf/Publications/Sogel\\_color\\_chart\\_2010\\_EN.pdf](http://www.sogel.ca/images/stories/pdf/Publications/Sogel_color_chart_2010_EN.pdf)

Q: How are the units installed?

A: Installation can be easily done by any experienced plumber. Installation documentation can be found at: <http://www.tahara-ablution.com/technical.html>

Q: Are there any special installation considerations?

A: The floor the units rest on should be level and flat so that the units mate up properly and accurately.

Q: What additional materials are required to complete the installation?

A: Basic plumbing piping and fittings. Each M1000 comes with drain fitting, gasket, and elbow.

Q: Is there a cover available for the exposed sides.

A: Yes, a stainless steel cover has been developed and features clearance holes for fixing screws.

 **TAHARA**  
[www.tahara-ablution.com](http://www.tahara-ablution.com)  
*proudly made in Canada*

### TAHARA – ABLUTION SYSTEMS

532 2A Avenue West, Brooks, Alberta, Canada

Contact Ayman Ahmad: **+1.403.973.0884** or

**sales@tahara-ablution.com**